

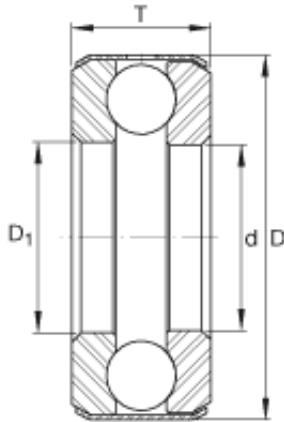

Bearing USA CORP.



INA B5 thrust ball bearings

Bearing No. B5

Size	19.05x37.313x15.88 mm
Bore Diameter	19,05 mm
Outer Diameter	37,313 mm
Width	15,88 mm
d	3/4 inch
d	19,05 mm
D	1,469 inch
D	37,313 mm
T	0,625 inch
T	15,88 mm
D ₁	0,781 inch
m	0,174 lbs / Weight
m	0,079 kg / Weight
C _a	4250 lbf / Dynamic load rating (axial)
C _a	18900 N / Dynamic load rating (axial)
C _{0a}	7300 lbf / Static load rating (axial)
C _{0a}	32500 N / Static load rating (axial)
Category	Thrust Ball Bearing
Inventory	0.0
Manufacturer Name	SCHAEFFLER GROUP
Minimum Buy Quantity	N/A
Weight / Kilogram	0.08
EAN	4012802308242

B5 Bearing 2D drawings and 3D CAD models



Bearing USA CORP.

Product Group	B00308
Rolling Element	Ball Bearing
Thrust Bearing	Yes
Single or Double Direction	Single Direction
Banded	Yes
Precision Class	ABEC 1 ISO P0
Component Description	Roller Assembly Plus Raceways
Other Features	Single Row Deep Groove Medium Cross Section Grooved Race Non Separable Full Complement Standard Oil Hole in Band
Long Description	3/4" Bore 1; 25/32" Bore 2; 1-15/32" Outside Diameter; 5/8" Height; Ball Bearing; Single Direction; Banded; ABEC 1 ISO P0 Precision
Inch - Metric	Inch
Category	Thrust Ball Bearings
UNSPSC	31171507
Harmonized Tariff Code	8482.10.50.08
Noun	Bearing
Keyword String	Ball Thrust
Manufacturer URL	http://www.ina.com
Manufacturer Item Number	B5HLG
Weight / LBS	0.174
Overall Height with Aligning Washer	0 Inch 0 Millimeter
Height	0.625 Inch 15.875 Millimeter
Bore 1	0.75 Inch 19.05 Millimeter
Bore 2	0.781 Inch 19.837 Millimeter
Outside Diameter	1.469 Inch 37.313

