

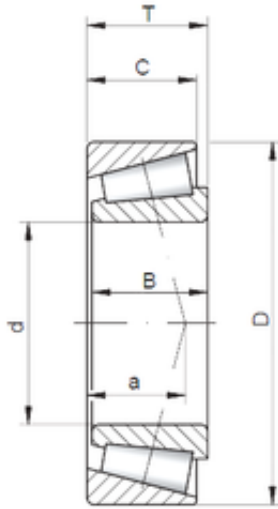

Bearing USA CORP.

50,8 mm x 88,9 mm x 22,225 mm ISO
370A/362A tapered roller bearings



Bearing No. 370A/362A

Size	50.8x88.9x20.638 mm
Bore Diameter	50,8 mm
Outer Diameter	88,9 mm
Width	20,638 mm
d	50,8 mm
D	88,9 mm
T	20,638 mm
B	22,225 mm
C	16,513 mm
a	4,3 mm

370A/362A Bearing 2D drawings and 3D CAD models